

LEGEND

- 1. UNREGISTERED PLAT
- 2. REGISTERED PLAT
- 3. UNREGISTERED UNIT
- 4. REGISTERED UNIT
- 5. UNREGISTERED COMMONS
- 6. REGISTERED COMMONS
- 7. UNREGISTERED CONDOMINIUM
- 8. REGISTERED CONDOMINIUM
- 9. UNREGISTERED TRACT
- 10. REGISTERED TRACT
- 11. UNREGISTERED LOT
- 12. REGISTERED LOT
- 13. UNREGISTERED AREA
- 14. REGISTERED AREA
- 15. UNREGISTERED CORNER
- 16. REGISTERED CORNER
- 17. UNREGISTERED POINT
- 18. REGISTERED POINT
- 19. UNREGISTERED LINE
- 20. REGISTERED LINE
- 21. UNREGISTERED SURFACE
- 22. REGISTERED SURFACE
- 23. UNREGISTERED EASEMENT
- 24. REGISTERED EASEMENT
- 25. UNREGISTERED ENCUMBRANCE
- 26. REGISTERED ENCUMBRANCE
- 27. UNREGISTERED INTEREST
- 28. REGISTERED INTEREST
- 29. UNREGISTERED RIGHT
- 30. REGISTERED RIGHT
- 31. UNREGISTERED POWER
- 32. REGISTERED POWER
- 33. UNREGISTERED CLAIM
- 34. REGISTERED CLAIM
- 35. UNREGISTERED DEFENSE
- 36. REGISTERED DEFENSE
- 37. UNREGISTERED PROTECTION
- 38. REGISTERED PROTECTION
- 39. UNREGISTERED REMEDY
- 40. REGISTERED REMEDY
- 41. UNREGISTERED ACTION
- 42. REGISTERED ACTION
- 43. UNREGISTERED PROCEEDING
- 44. REGISTERED PROCEEDING
- 45. UNREGISTERED MATTER
- 46. REGISTERED MATTER
- 47. UNREGISTERED CASE
- 48. REGISTERED CASE
- 49. UNREGISTERED BUSINESS
- 50. REGISTERED BUSINESS
- 51. UNREGISTERED TRANSACTION
- 52. REGISTERED TRANSACTION
- 53. UNREGISTERED DEALING
- 54. REGISTERED DEALING
- 55. UNREGISTERED CONTRACT
- 56. REGISTERED CONTRACT
- 57. UNREGISTERED AGREEMENT
- 58. REGISTERED AGREEMENT
- 59. UNREGISTERED INSTRUMENT
- 60. REGISTERED INSTRUMENT
- 61. UNREGISTERED DOCUMENT
- 62. REGISTERED DOCUMENT
- 63. UNREGISTERED RECORD
- 64. REGISTERED RECORD
- 65. UNREGISTERED ENTRY
- 66. REGISTERED ENTRY
- 67. UNREGISTERED ITEM
- 68. REGISTERED ITEM
- 69. UNREGISTERED OBJECT
- 70. REGISTERED OBJECT
- 71. UNREGISTERED SUBJECT
- 72. REGISTERED SUBJECT
- 73. UNREGISTERED MATTER
- 74. REGISTERED MATTER
- 75. UNREGISTERED CASE
- 76. REGISTERED CASE
- 77. UNREGISTERED BUSINESS
- 78. REGISTERED BUSINESS
- 79. UNREGISTERED TRANSACTION
- 80. REGISTERED TRANSACTION
- 81. UNREGISTERED DEALING
- 82. REGISTERED DEALING
- 83. UNREGISTERED CONTRACT
- 84. REGISTERED CONTRACT
- 85. UNREGISTERED AGREEMENT
- 86. REGISTERED AGREEMENT
- 87. UNREGISTERED INSTRUMENT
- 88. REGISTERED INSTRUMENT
- 89. UNREGISTERED DOCUMENT
- 90. REGISTERED DOCUMENT
- 91. UNREGISTERED RECORD
- 92. REGISTERED RECORD
- 93. UNREGISTERED ENTRY
- 94. REGISTERED ENTRY
- 95. UNREGISTERED ITEM
- 96. REGISTERED ITEM
- 97. UNREGISTERED OBJECT
- 98. REGISTERED OBJECT
- 99. UNREGISTERED SUBJECT
- 100. REGISTERED SUBJECT

NOTES

1. CONDA MINIMUM UNIT
2. UNREGISTERED UNIT
3. REGISTERED UNIT
4. UNREGISTERED COMMONS
5. REGISTERED COMMONS
6. UNREGISTERED CONDOMINIUM
7. REGISTERED CONDOMINIUM
8. UNREGISTERED TRACT
9. REGISTERED TRACT
10. UNREGISTERED LOT
11. REGISTERED LOT
12. UNREGISTERED AREA
13. REGISTERED AREA
14. UNREGISTERED CORNER
15. REGISTERED CORNER
16. UNREGISTERED POINT
17. REGISTERED POINT
18. UNREGISTERED LINE
19. REGISTERED LINE
20. UNREGISTERED SURFACE
21. REGISTERED SURFACE
22. UNREGISTERED EASEMENT
23. REGISTERED EASEMENT
24. UNREGISTERED ENCUMBRANCE
25. REGISTERED ENCUMBRANCE
26. UNREGISTERED INTEREST
27. REGISTERED INTEREST
28. UNREGISTERED RIGHT
29. REGISTERED RIGHT
30. UNREGISTERED POWER
31. REGISTERED POWER
32. UNREGISTERED CLAIM
33. REGISTERED CLAIM
34. UNREGISTERED DEFENSE
35. REGISTERED DEFENSE
36. UNREGISTERED PROTECTION
37. REGISTERED PROTECTION
38. UNREGISTERED REMEDY
39. REGISTERED REMEDY
40. UNREGISTERED ACTION
41. REGISTERED ACTION
42. UNREGISTERED PROCEEDING
43. REGISTERED PROCEEDING
44. UNREGISTERED MATTER
45. REGISTERED MATTER
46. UNREGISTERED CASE
47. REGISTERED CASE
48. UNREGISTERED BUSINESS
49. REGISTERED BUSINESS
50. UNREGISTERED TRANSACTION
51. REGISTERED TRANSACTION
52. UNREGISTERED DEALING
53. REGISTERED DEALING
54. UNREGISTERED CONTRACT
55. REGISTERED CONTRACT
56. UNREGISTERED AGREEMENT
57. REGISTERED AGREEMENT
58. UNREGISTERED INSTRUMENT
59. REGISTERED INSTRUMENT
60. UNREGISTERED DOCUMENT
61. REGISTERED DOCUMENT
62. UNREGISTERED RECORD
63. REGISTERED RECORD
64. UNREGISTERED ENTRY
65. REGISTERED ENTRY
66. UNREGISTERED ITEM
67. REGISTERED ITEM
68. UNREGISTERED OBJECT
69. REGISTERED OBJECT
70. UNREGISTERED SUBJECT
71. REGISTERED SUBJECT
72. UNREGISTERED MATTER
73. REGISTERED MATTER
74. UNREGISTERED CASE
75. REGISTERED CASE
76. UNREGISTERED BUSINESS
77. REGISTERED BUSINESS
78. UNREGISTERED TRANSACTION
79. REGISTERED TRANSACTION
80. UNREGISTERED DEALING
81. REGISTERED DEALING
82. UNREGISTERED CONTRACT
83. REGISTERED CONTRACT
84. UNREGISTERED AGREEMENT
85. REGISTERED AGREEMENT
86. UNREGISTERED INSTRUMENT
87. REGISTERED INSTRUMENT
88. UNREGISTERED DOCUMENT
89. REGISTERED DOCUMENT
90. UNREGISTERED RECORD
91. REGISTERED RECORD
92. UNREGISTERED ENTRY
93. REGISTERED ENTRY
94. UNREGISTERED ITEM
95. REGISTERED ITEM
96. UNREGISTERED OBJECT
97. REGISTERED OBJECT
98. UNREGISTERED SUBJECT
99. REGISTERED SUBJECT
100. UNREGISTERED MATTER

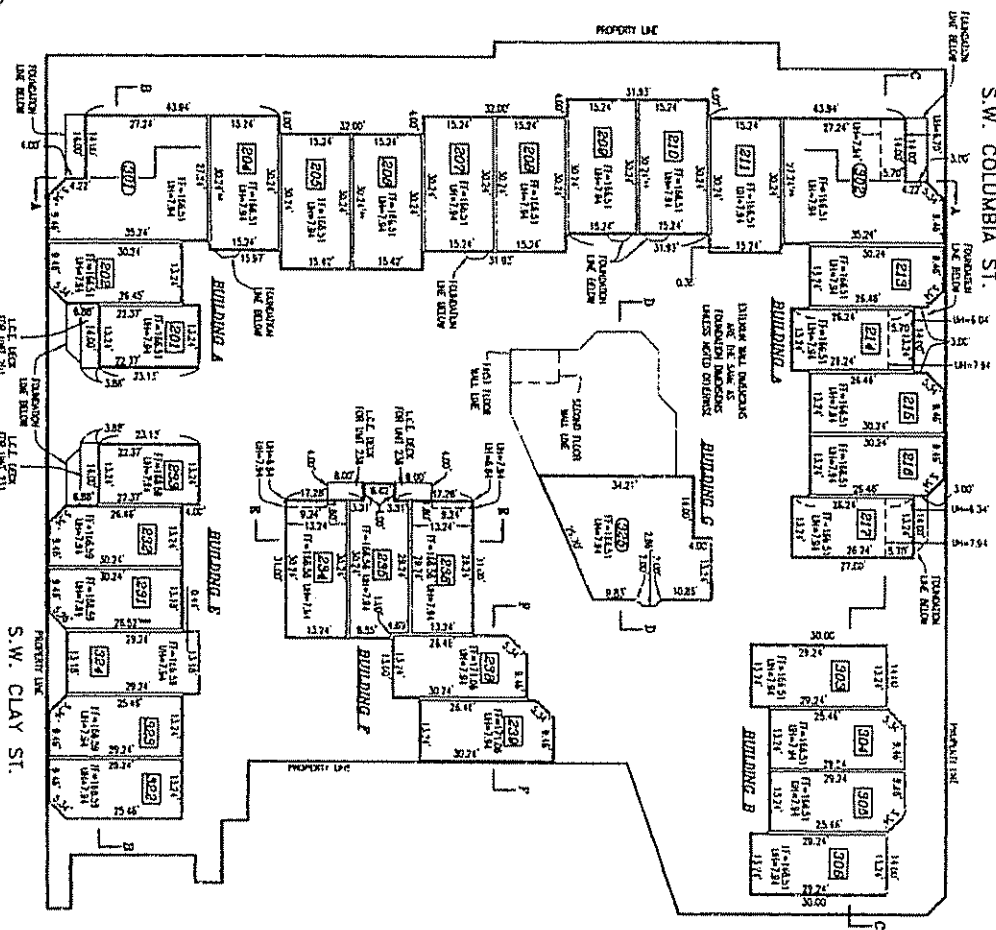
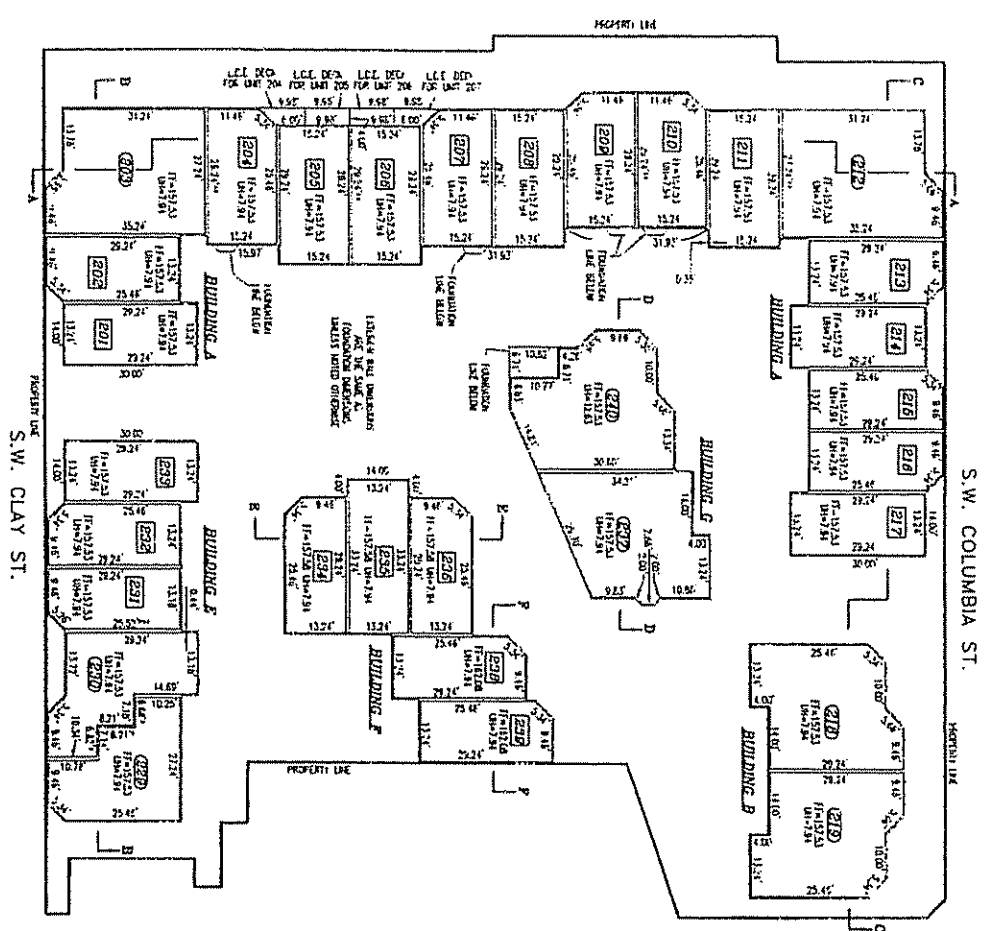

BOOK 1270 PAGE 91

CLAY STREET COMMONS, A CONDOMINIUM

THAT TRACT OF LAND DESCRIBED IN DOCUMENT NO. 2004-205139, MULTNOMAH COUNTY DEED RECORDS, BEING A PORTION OF BLOCK "X", CARRIERS ADDITION TO THE CITY OF PORTLAND, SITUATED IN THE NE 1/4 OF SECTION 4, T15, R1E, W1E, IN THE CITY OF PORTLAND, MULTNOMAH COUNTY, OREGON

SURVEYED JANUARY 12TH, 2005

JOB NO. 04-367 P-04-36704-67-1-LINE

REGISTERED PLAT AND SURVEY LAND SURVEYOR

OREGON JAN 13, 1984

W.B. WELLS

EXPIRES 12-31-00

1. HANDED TO POWER, STATE THAT THIS PLAN OR SURVEY WAS PREPARED USING METRETT-PACKARD PRODUCT NO. 818424 ON ONE 8 BROOM POLYESTER FILM.

2. I HEREBY CERTIFY THAT THIS IS A TRUE AND EXACT COPY OF THE ORIGINAL PLAN.

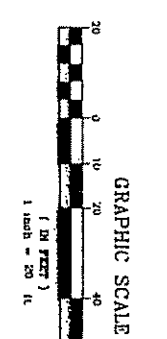

W.B. WELLS

REGISTERED PLAT AND SURVEY LAND SURVEYOR

OREGON JAN 13, 1984

W.B. WELLS

EXPIRES 12-31-00

SHEET 2 OF 5

P-04-36704-67-1-LINE

- LEGEND**
- 1 - L.L. - DOUBLE LINED UTILITY
 - 2 - L.L. - SINGLE LINED UTILITY
 - 3 - L.L. - UNLINED UTILITY
 - 4 - L.L. - UNLINED UTILITY
 - 5 - L.L. - UNLINED UTILITY
 - 6 - L.L. - UNLINED UTILITY
 - 7 - L.L. - UNLINED UTILITY
 - 8 - L.L. - UNLINED UTILITY
 - 9 - L.L. - UNLINED UTILITY
 - 10 - L.L. - UNLINED UTILITY
 - 11 - L.L. - UNLINED UTILITY
 - 12 - L.L. - UNLINED UTILITY
 - 13 - L.L. - UNLINED UTILITY
 - 14 - L.L. - UNLINED UTILITY
 - 15 - L.L. - UNLINED UTILITY
 - 16 - L.L. - UNLINED UTILITY
 - 17 - L.L. - UNLINED UTILITY
 - 18 - L.L. - UNLINED UTILITY
 - 19 - L.L. - UNLINED UTILITY
 - 20 - L.L. - UNLINED UTILITY
 - 21 - L.L. - UNLINED UTILITY
 - 22 - L.L. - UNLINED UTILITY
 - 23 - L.L. - UNLINED UTILITY
 - 24 - L.L. - UNLINED UTILITY
 - 25 - L.L. - UNLINED UTILITY
 - 26 - L.L. - UNLINED UTILITY
 - 27 - L.L. - UNLINED UTILITY
 - 28 - L.L. - UNLINED UTILITY
 - 29 - L.L. - UNLINED UTILITY
 - 30 - L.L. - UNLINED UTILITY
 - 31 - L.L. - UNLINED UTILITY
 - 32 - L.L. - UNLINED UTILITY
 - 33 - L.L. - UNLINED UTILITY
 - 34 - L.L. - UNLINED UTILITY
 - 35 - L.L. - UNLINED UTILITY
 - 36 - L.L. - UNLINED UTILITY
 - 37 - L.L. - UNLINED UTILITY
 - 38 - L.L. - UNLINED UTILITY
 - 39 - L.L. - UNLINED UTILITY
 - 40 - L.L. - UNLINED UTILITY
 - 41 - L.L. - UNLINED UTILITY
 - 42 - L.L. - UNLINED UTILITY
 - 43 - L.L. - UNLINED UTILITY
 - 44 - L.L. - UNLINED UTILITY
 - 45 - L.L. - UNLINED UTILITY
 - 46 - L.L. - UNLINED UTILITY
 - 47 - L.L. - UNLINED UTILITY
 - 48 - L.L. - UNLINED UTILITY
 - 49 - L.L. - UNLINED UTILITY
 - 50 - L.L. - UNLINED UTILITY
 - 51 - L.L. - UNLINED UTILITY
 - 52 - L.L. - UNLINED UTILITY
 - 53 - L.L. - UNLINED UTILITY
 - 54 - L.L. - UNLINED UTILITY
 - 55 - L.L. - UNLINED UTILITY
 - 56 - L.L. - UNLINED UTILITY
 - 57 - L.L. - UNLINED UTILITY
 - 58 - L.L. - UNLINED UTILITY
 - 59 - L.L. - UNLINED UTILITY
 - 60 - L.L. - UNLINED UTILITY
 - 61 - L.L. - UNLINED UTILITY
 - 62 - L.L. - UNLINED UTILITY
 - 63 - L.L. - UNLINED UTILITY
 - 64 - L.L. - UNLINED UTILITY
 - 65 - L.L. - UNLINED UTILITY
 - 66 - L.L. - UNLINED UTILITY
 - 67 - L.L. - UNLINED UTILITY
 - 68 - L.L. - UNLINED UTILITY
 - 69 - L.L. - UNLINED UTILITY
 - 70 - L.L. - UNLINED UTILITY
 - 71 - L.L. - UNLINED UTILITY
 - 72 - L.L. - UNLINED UTILITY
 - 73 - L.L. - UNLINED UTILITY
 - 74 - L.L. - UNLINED UTILITY
 - 75 - L.L. - UNLINED UTILITY
 - 76 - L.L. - UNLINED UTILITY
 - 77 - L.L. - UNLINED UTILITY
 - 78 - L.L. - UNLINED UTILITY
 - 79 - L.L. - UNLINED UTILITY
 - 80 - L.L. - UNLINED UTILITY
 - 81 - L.L. - UNLINED UTILITY
 - 82 - L.L. - UNLINED UTILITY
 - 83 - L.L. - UNLINED UTILITY
 - 84 - L.L. - UNLINED UTILITY
 - 85 - L.L. - UNLINED UTILITY
 - 86 - L.L. - UNLINED UTILITY
 - 87 - L.L. - UNLINED UTILITY
 - 88 - L.L. - UNLINED UTILITY
 - 89 - L.L. - UNLINED UTILITY
 - 90 - L.L. - UNLINED UTILITY
 - 91 - L.L. - UNLINED UTILITY
 - 92 - L.L. - UNLINED UTILITY
 - 93 - L.L. - UNLINED UTILITY
 - 94 - L.L. - UNLINED UTILITY
 - 95 - L.L. - UNLINED UTILITY
 - 96 - L.L. - UNLINED UTILITY
 - 97 - L.L. - UNLINED UTILITY
 - 98 - L.L. - UNLINED UTILITY
 - 99 - L.L. - UNLINED UTILITY
 - 100 - L.L. - UNLINED UTILITY

- NOTES**
1. THESE SPACES AND UTILITY SPACES ARE THE PROPERTY OF THE CLAY STREET COMMONS, A CONDOMINIUM.
 2. THE CLAY STREET COMMONS, A CONDOMINIUM IS A TRACT OF LAND DESCRIBED IN DOCUMENT NO. 2004-205129, MULTNOMAH COUNTY DEED RECORDS BEING A PORTION OF BLOCK "C", CARRIERS ADDITION TO THE CITY OF PORTLAND, SITUATED IN THE NE 1/4 OF SECTION 4, T1S, R1E, W1M, IN THE CITY OF PORTLAND, MULTNOMAH COUNTY, OREGON.
 3. THESE SPACES ARE TO BE USED AS PARKING SPACES FOR THE CLAY STREET COMMONS, A CONDOMINIUM.
 4. THE CLAY STREET COMMONS, A CONDOMINIUM IS A TRACT OF LAND DESCRIBED IN DOCUMENT NO. 2004-205129, MULTNOMAH COUNTY DEED RECORDS BEING A PORTION OF BLOCK "C", CARRIERS ADDITION TO THE CITY OF PORTLAND, SITUATED IN THE NE 1/4 OF SECTION 4, T1S, R1E, W1M, IN THE CITY OF PORTLAND, MULTNOMAH COUNTY, OREGON.
 5. THESE SPACES ARE TO BE USED AS PARKING SPACES FOR THE CLAY STREET COMMONS, A CONDOMINIUM.
 6. THE CLAY STREET COMMONS, A CONDOMINIUM IS A TRACT OF LAND DESCRIBED IN DOCUMENT NO. 2004-205129, MULTNOMAH COUNTY DEED RECORDS BEING A PORTION OF BLOCK "C", CARRIERS ADDITION TO THE CITY OF PORTLAND, SITUATED IN THE NE 1/4 OF SECTION 4, T1S, R1E, W1M, IN THE CITY OF PORTLAND, MULTNOMAH COUNTY, OREGON.
 7. THESE SPACES ARE TO BE USED AS PARKING SPACES FOR THE CLAY STREET COMMONS, A CONDOMINIUM.
 8. THE CLAY STREET COMMONS, A CONDOMINIUM IS A TRACT OF LAND DESCRIBED IN DOCUMENT NO. 2004-205129, MULTNOMAH COUNTY DEED RECORDS BEING A PORTION OF BLOCK "C", CARRIERS ADDITION TO THE CITY OF PORTLAND, SITUATED IN THE NE 1/4 OF SECTION 4, T1S, R1E, W1M, IN THE CITY OF PORTLAND, MULTNOMAH COUNTY, OREGON.
 9. THESE SPACES ARE TO BE USED AS PARKING SPACES FOR THE CLAY STREET COMMONS, A CONDOMINIUM.
 10. THE CLAY STREET COMMONS, A CONDOMINIUM IS A TRACT OF LAND DESCRIBED IN DOCUMENT NO. 2004-205129, MULTNOMAH COUNTY DEED RECORDS BEING A PORTION OF BLOCK "C", CARRIERS ADDITION TO THE CITY OF PORTLAND, SITUATED IN THE NE 1/4 OF SECTION 4, T1S, R1E, W1M, IN THE CITY OF PORTLAND, MULTNOMAH COUNTY, OREGON.

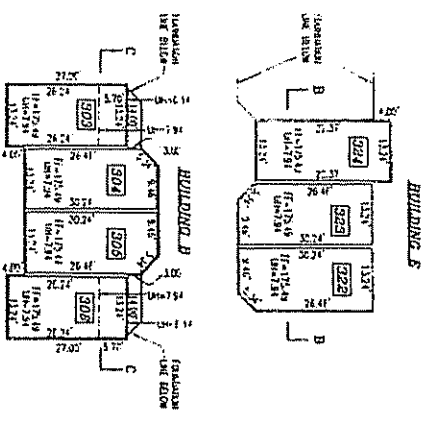

FLOOR PLAN - 4TH LEVEL

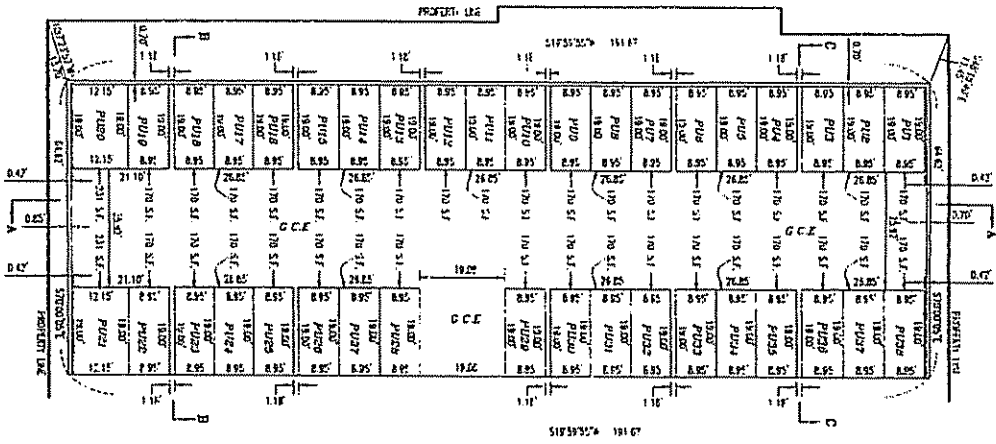

BASEMENT PARKING - LOWER LEVEL

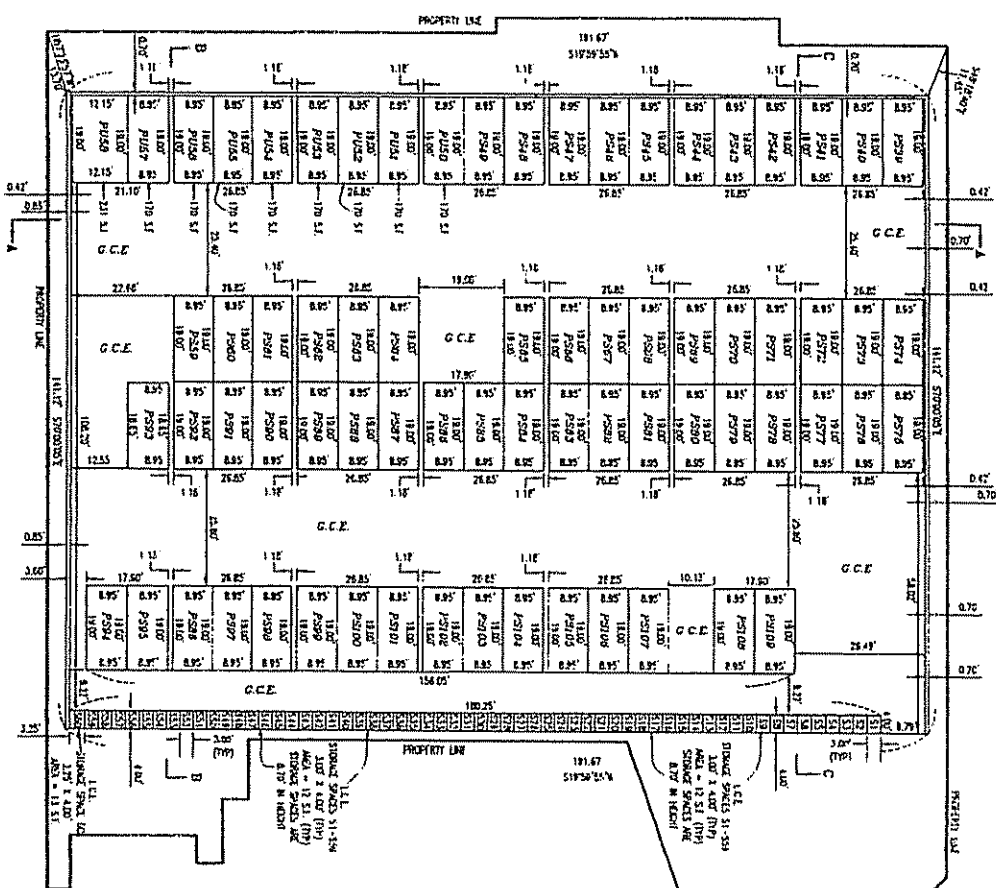

BASEMENT PARKING - UPPER LEVEL



GRAPHIC SCALE (IN FEET)



W.B. WELLS
ENGINEERING, INC.
1000 NE OREGON STREET
PORTLAND, OREGON 97232
TEL: 503-253-1100
WWW.WB-WELLS.COM

REGISTERED PROFESSIONAL ENGINEER
LAND SURVEYOR
NO. 20,202
OREGON
JULY 13, 1984
HAROLD W. WELLS
LAND SURVEYOR

L. RANDY L. RINGER, STATE THAT THIS PLAN OR SURVEY WAS PREPARED USING HERETO-FORWARD PRODUCED AND STORED ON CD-R OR DVD BY THE ORIGINAL PLAT

SHEET 3 OF 5
P-04-28704-67R1206

BOOK 1270 PAGE 92
CLAY STREET COMMONS, A CONDOMINIUM
THAT TRACT OF LAND DESCRIBED IN DOCUMENT NO. 2004-205129, MULTNOMAH COUNTY DEED RECORDS BEING A PORTION OF BLOCK "C", CARRIERS ADDITION TO THE CITY OF PORTLAND, SITUATED IN THE NE 1/4 OF SECTION 4, T1S, R1E, W1M, IN THE CITY OF PORTLAND, MULTNOMAH COUNTY, OREGON.
SURVEYED JANUARY 12TH, 2005
JOB NO. 04-287
P-04-28704-67R1206

